

A Model Numbering system for describing cylinder size and variable construction features that are available for use in all "standard" cylinders is explained below.

This Model Number consists of Letter and Number Codes which represent the desired choices between available variables which make up

the cylinder construction details.

Cylinders may be ordered with many non-standard features that cannot be identified in coded number terms. When special features are desired, clearly describe requirements with supplemental callout of details.

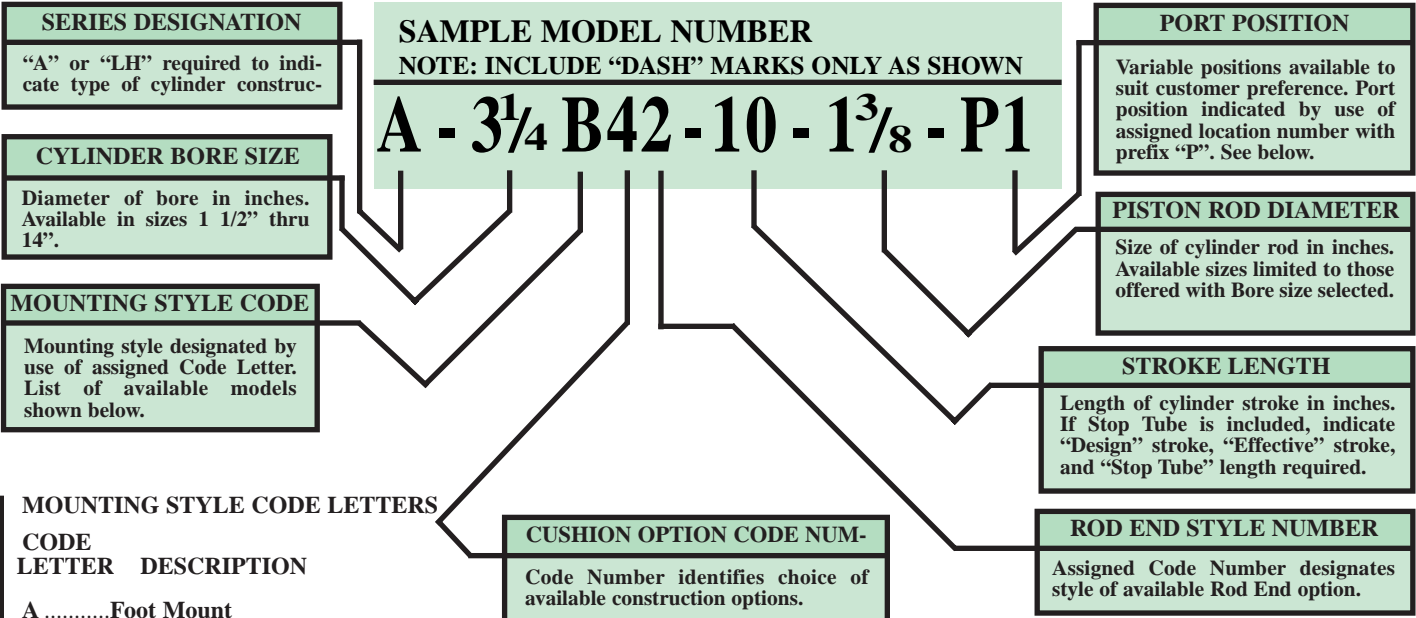

**MOUNTING STYLE CODE LETTERS**

CODE LETTER	DESCRIPTION
A	.....Foot Mount NFA style MS2
B	.....Clevis Mount NFA style MP1
BR	.....Detachable Clevis Mount NFA style MP2
BX	.....Single Lug Pivot Mount NFA style MP3
C	.....Front Flange Mount NFA style MF1 & ME3
D	.....Rear Flange Mount NFA style MF2 & ME4
E	.....Front Trunnion Mount NFA style MT1
F	.....Rear Trunnion Mount NFA style MT2
G	.....Side Mount NFA style MS4
J	.....End Lug Mount NFA style MS7
K	.....Centerline Lug Mount NFA style MS3
L	.....Extended Tie Rod Mount NFA style MX1, MX2, & MX3
N	.....Intermediate Trunnion Mount NFA style MT4
P	.....Square Front Flange Mount NFA style MF5
R	.....Square Rear Flange Mount NFA style MF6
UB	.....Spherical Bushing Mount NFA style MPU3
W	.....Angle Foot Mount NFA style MS1

**CUSHION CODE NUMBERS**

CODE NUMBER	DESCRIPTION
0	.....Non-cushioned (No cushion at either end)
2	.....Adjustable Cushion on Rod End (Cushion at Front Head End only)
3	.....Adjustable Cushion on Blind End (Cushion at Rear Head End only)
4	.....Adjustable Cushion on Both Ends

**PORT LOCATION POSITION NUMBERS**

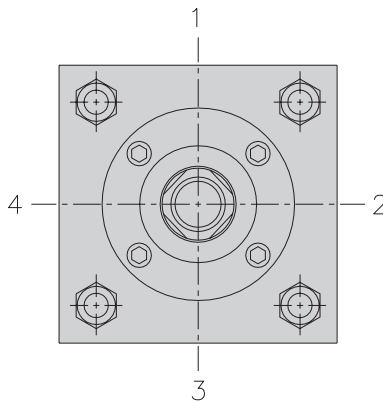

**ROD END STYLE CODE NUMBERS**

CODE NUMBER	DESCRIPTION
<u>STANDARD</u>	
2	.....Small Male Thread NFA type SM
4	.....Short Style Female Thread NFA type SF
<u>OPTIONAL</u>	
1	.....Full Diameter Male Thread NFA type FM
3	.....Long Style Female Thread NFA type LF
5	.....Studded Male Thread Dimensions equal to Style 2 Rod End
6	.....Special Rod End Made per custom specifications
8	.....Intermediate Male Thread NFA type IM
0	.....Plain Rod End

Cylinder side positions are numbered in a clockwise direction when viewing the unit from the rod end with location #1 being at the top as shown in the reference view.

Double rod end models are numbered in a similar manner with the primary mounting end being considered as the "rod end" for side numbering purposes. If the cylinder ports are in line at both ends of the unit, use only one number to designate the required position. When the cylinder is to be provided with multiple ports, specify the side position numbers which correspond to the desired locations.

M .....Double Rod End Model  
Insert "M" in front of Mtg. Style Code Letter to designate Double Rod End construction. Mounting styles available are: MA, MC, ME, MG, MJ, MK, ML, MN, MP, and MW.

**NON-STANDARD MODIFICATIONS AVAILABLE**  
Variations in construction involving use of non-standard dimensions, materials, or cylinder feature modifications are available upon request. Clearly describe any such requirement that is not identifiable by coded Model Number.